

TECHNICAL CHARACTERISTICS OF THE CERAMIC DISCS:

Material:	AL₂O₃
Surface roughness Ra:	0.2 μm
Contact surface area:	50-80%

TECHNICAL CHARACTERISTICS OF THE CARTRIDGE:

Mixing angle:	90°
Max. water pressure:	35 bar / 500 psi
Max temperature:	90°C / 194°F

Max. tightening torque:

12 Nm / 106 lbf·in

Pressure test:

Pneumatic: **6 bar / 87 psi**

Hydraulic: **35 bar / 500 psi**

Constant flow rate in the 40°-90° range.

Flow rate:

(3 bar / 45 psi, test faucet, EN 817)

14 l/min / 3.7 gpm without resistance

Endurance test:

EN 817 70 000 cycles

ASME A 112.18.1 500 000 cycles

- Rotational action provides on-off & temperature control only (no volume control)
- Characteristics & operation are as per basic model KR-28
- Mixed water flows through cartridge stem into the spout
- Opens up new faucet design possibilities
Simplifies faucet body design
- There are two types of this model:

FTJ-28 - Open-Anti-Clockwise, assembled with gray ring

FTB-28 - Open-Clockwise, assembled with black ring

FLOW RATE & HYSTERESIS CURVES

Test faucet, without resistance
Water pressure: 3 bar

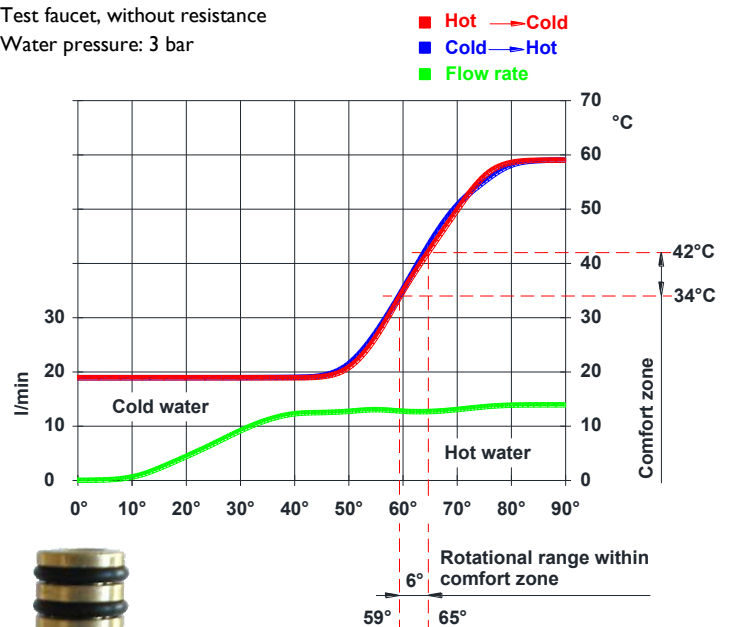

TECHNICAL CHARACTERISTICS OF THE CERAMIC DISCS:

Material:	AL₂O₃
Surface roughness Ra:	0.2 μm
Contact surface area:	50-80%

TECHNICAL CHARACTERISTICS OF THE CARTRIDGE:

Mixing angle:	90°
Max temperature:	90°C/194°F
Recommended tightening torque:	12-13 Nm / 106-115 lbf·in
Pressure test:	
Pneumatic:	6 bar / 87 psi
Hydraulic:	35 bar / 500 psi

Constant flow rate in the 30°-90° range.

Flow rate:

(3 bar / 45 psi, test faucet, EN 817)

26 l/min / 6.9 gpm without resistance

Endurance test:

EN 817 70 000 cycles

ASME A 112.18.1M 500 000 cycles

- Rotational action provides on-off and temperature control.
- Characteristics and operation are as per basic model KR-35.
- Mixed water flows through cartridge stem into the spout.
- Ideal for new faucet designs.
- Different stem specification also available.

Models FTB-35A • FTB-35B • FTB-35C • FTB-35D

Open-clockwise black hot limit stop

Models FTJ-35A • FTJ-35B • FTJ-35C • FTJ-35D

Open-anti-clockwise grey hot limit stop

FLOW RATE & HYSTERESIS CURVES

Shower faucet, without resistance
Water pressure: 3 bar

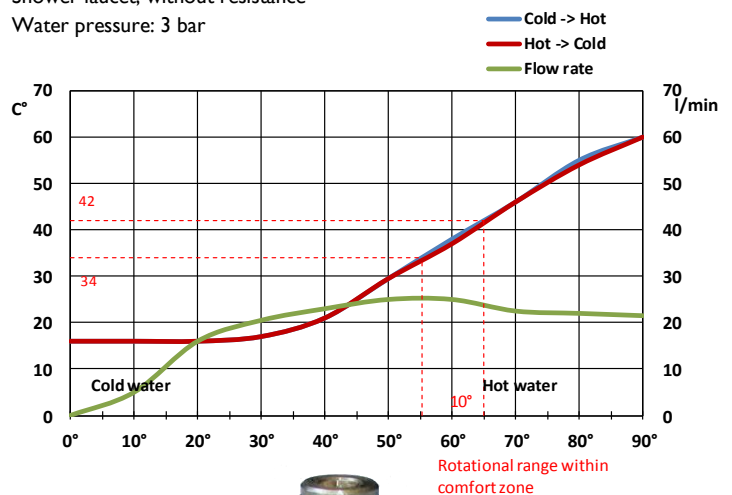

FT-35

CARTRIDGES

A • B • C • D

FT-35 with „OM” stem

FT-35 with „FR” stem

Cartridge

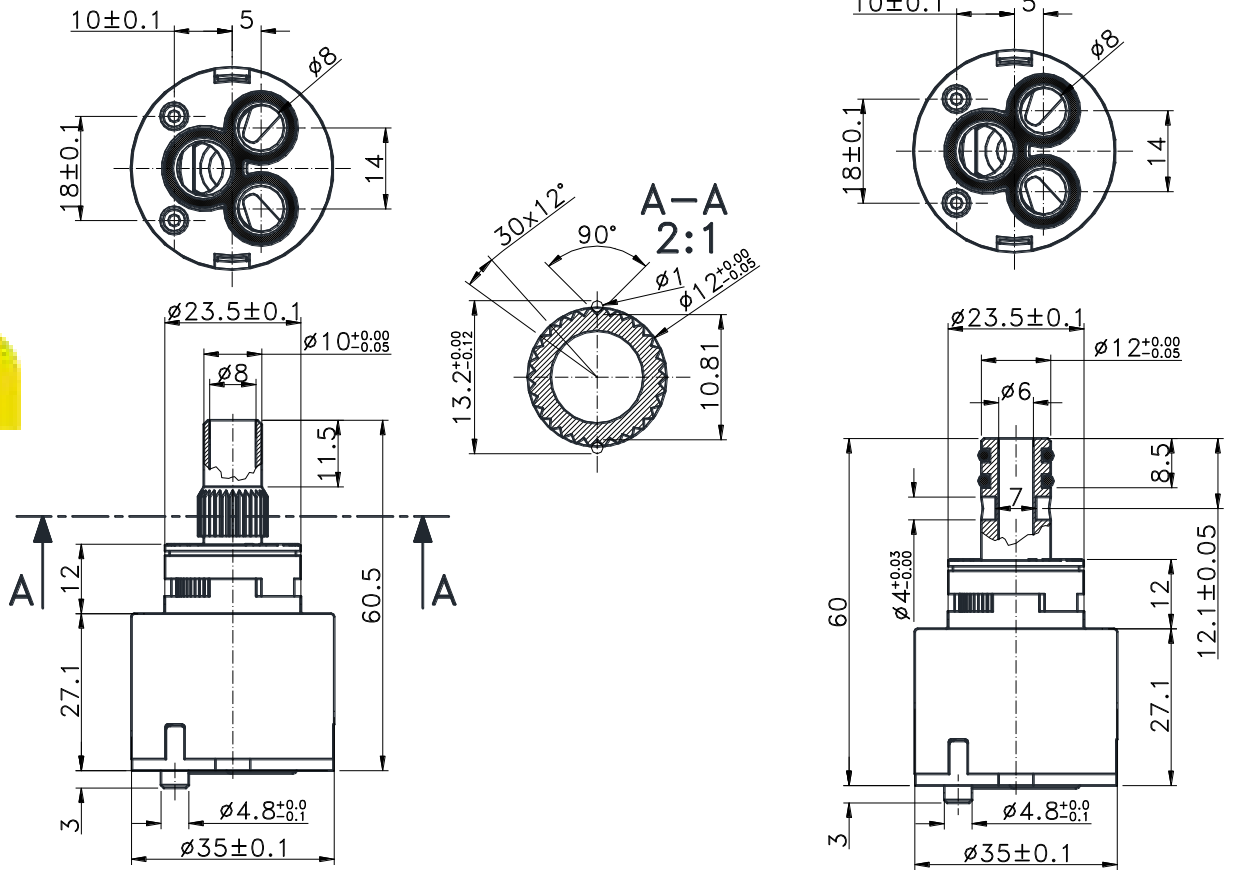

DIFFERENT STEM SPECIFICATION ALSO AVAILABLE.

Faucet

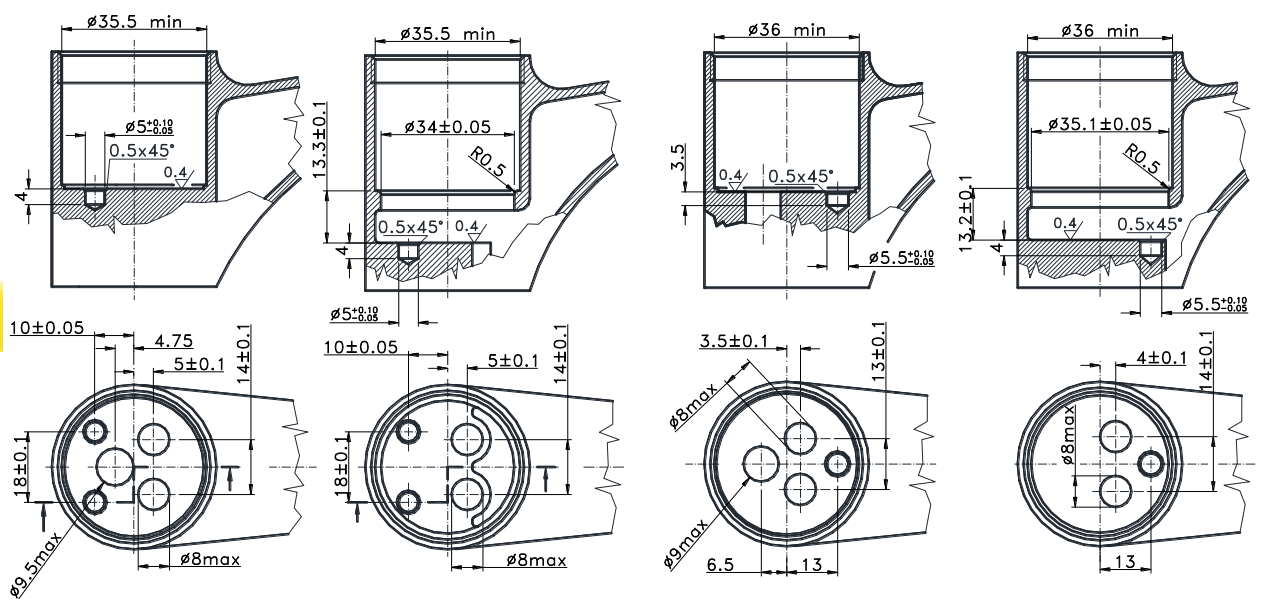

FT-35 A

FT-35 B

FT-35 C

FT-35 D