

Pure Freude
an Wasser

GROHE

new

**INTRODUCING
GROHE KITCHEN SINKS**
MADE TO MATCH IN FORM AND FUNCTION



Think of a space where people come together. A space where any kind of mood can be translated into an endless number of delicious dishes and drinks. A space where you not only express your individuality, but also try new recipes and explore millions of tastes.

CONTENTS

INTRODUCING GROHE KITCHEN SINKS	06
QUALITY THAT LASTS A LIFETIME	10

STAINLESS STEEL SINKS

PRODUCT FEATURES, FINISHES AND MOUNTING TYPES	14
MANUFACTURING PROCESS	18

PRODUCT LINES	22
K1000	24
K800	30
K700 UNDERMOUNT	36
K700	42
K500	50
K400+	54
K400	58
K300	62
K200	66

PERFECT MATCH	72
---------------	----



COMPOSITE SINKS

PRODUCT FEATURES, FINISHES AND MOUNTING TYPES	76
MANUFACTURING PROCESS	80

PRODUCT LINES	84
K700 UNDERMOUNT	86
K700	90
K500	96
K400	102
K200	106

PERFECT MATCH	112
---------------	-----

PRODUCT FEATURES OVERVIEW	114
KITCHEN SYSTEMS	116
WORLD OF GROHE	118



INTRODUCING GROHE KITCHEN SINKS

Add up how much time you spend at your kitchen sink. Filling pots, preparing veg, washing up after a big meal. It's a place you will stop at countless times each day, so why not choose a sink that exceeds your needs in terms of quality, design and features?

GROHE sinks have been designed to fit every type of kitchen scheme, with a range of innovative, modern designs perfect for your space. You can choose between a sleek, hardwearing stainless steel model or a super-durable composite available in two contemporary colours. You will find compact models with integrated drainers, large double sinks for when you need to spread out, and chic built-in sinks that fit flush to your worktop. With features like the GROHE QuickFix system and reversible designs as standard, you can have your new GROHE sink installed in minutes with no fuss or hassle.

We are also confident that you will love the special features on offer, like the automatic waste that means never plunging your hand into dirty water again. Thanks to GROHE Whisper technology you can even be sure that this will be your quietest sink ever - for composite sinks the material itself reduces the noise from water flow and for GROHE stainless steel sinks special integrated insulation achieves the same effect. With a sink from GROHE you'll notice the difference, making every time you use your sink less of a chore.



FEEL THE BENEFITS INNOVATIVE FEATURES AND FUNCTIONS

We can't claim to make washing up a joy, but thanks to the smart, useful features of every GROHE sink, we certainly believe that we can make your sink somewhere you are happy to spend some time. With a GROHE sink, cleaning is easier, draining the bowl can be done remotely, and even the sound of the water running is minimised. Just select your ideal size and style – installation is effortless and the benefits speak for themselves.

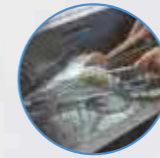

Spacious bowls

Thanks to our innovative manufacturing techniques, all GROHE sinks feature bowls with a generous depth of min. 16 cm, maximising space for washing large pots with ease.



Pre-punched tap holes

The most GROHE sinks come with two pre-punched tap holes, meaning no additional tools are required and many sinks are reversible and can be installed as either left- or right-handed option.

Overflow

The overflow, available on all GROHE sinks, avoids any spillage of water in case the taps are inadvertently left open. The perimetric solution available on some models improves the look, thanks to its squared-out and essential shape.



Waste fitting with remote control

GROHE sinks are equipped with a 3.5" waste fitting and practical strainer plug that prevents solids and leftovers from flowing away with the waste water. The steel cap available on some models adds elegance to the bowl and hides any residue collected in the underlying basket.



Siphon included

For a quick and hassle-free installation each sink comes with an under-sink siphon complementing the scope of delivery and guaranteeing an ALL IN ONE solution.

Water drainage

Drainage from the bowl's base and drainers is an important feature, always well cared for on GROHE sinks. In the squared-out, flat-bottomed sinks, good drainage is ensured by the elegant diamond-shaped creases that make the water flow away more easily.

QUALITY THAT LASTS A LIFETIME

GROHE's reputation for quality of course extends to every sink in our range. With steel thicknesses ranging from 0.6 mm on the entry price segment to 1 mm on the premium ranges, each stainless steel sink uses steel above industry standards, and our patented brushing process creates a super-smooth surface that is easy to clean. Our composite sinks produced in a special computercontrolled casting process use 76 % quartz mixed with acrylic resin for a super hardwearing and minimum 7 mm thick material offering superlative durability and function, with smooth pore-free surface that is resistant to heat, dents scratches and stains, hygienic and easy to clean. For additional reassurance, each GROHE sink comes with a five year warranty, just like our taps.





STAINLESS STEEL SINKS

PRODUCT FEATURES, FINISHES AND MOUNTING TYPES

Whatever the design of your kitchen you will find a GROHE sink that complements it beautifully. The range includes standard built-in models, flush-mounted, under-mounted and flat-edge models, with eight different designs, from timeless to crisply minimal.

You can choose from two different stainless steel grades – AISI 304 and AISI 316 – according to your specifications too, so whether you are kitting out a compact kitchen or looking for a centrepiece sink for your island unit GROHE has a model that is just right, and at a price point that suits.



GROHE StarLight

All GROHE sinks use stainless steel graded above the industry average, so you can be confident of their quality and durability. Our innovative brushing technique means that the sparkling steel surface is ultra smooth for easier cleaning.



GROHE QuickFix

Install your sink swiftly and easily thanks to the GROHE QuickFix system (kit supplied). With two pre-punched tap holes most of our sinks are easily reversible, giving you the flexibility you need for any design scheme.



GROHE Whisper

Shhh! A special insulation on the underside of the sink means that noise from running water and handling pots and pans is reduced to a minimum.

AISI 304

On every sink model GROHE uses AISI 304 stainless steel, exceeding the quality standard of the industry. Thanks to the high percentages of chrome and nickel it contains, AISI 304 steel gives a particularly bright finish and makes the products durable against rust and corrosion.

AISI 316 (MARINE STEEL)

With AISI 316 available on the K400+ series, GROHE offers a durable solution even for regions with salty, rust-causing climates. Also known as the "marine steel", AISI 316 is mainly used in the shipbuilding or chemical industries as it is famous for its high percentages of chrome, nickel and molybdenum which make the steel extremely resistant to rust and corrosion and even acids or chlorine.

PATENTED BRUSHING TECHNIQUE (GROHE SATIN FINISH)

The K300 – K1000 series are treated with special vegetable fibres (Tampico) that give the sinks their characteristic extra-fine satin finish that is highly elegant and functional. GROHE's patented brushing technique creates a stainless steel surface that is smoother and less porous than many other brands, making cleaning your sink easier and significantly enhancing its durability.

**SPACIOUS BOWLS**

Thanks to our innovative manufacturing techniques, all GROHE sinks feature bowls with a generous depth of 16 cm, maximising space for washing large pots with ease.

**WASTE FITTING WITH REMOTE CONTROL**

Supplied with each model, the remote control fitting allows you to empty the sink without reaching into the dirty water – clean and convenient.

**STANDARD BUILT-IN**

Traditional built-in with a vertical 8mm edge.

**FLAT-EDGE**

An original edge with an inclined 3mm high profile, matching an extreme elegance with ease of installation.

**UNDERMOUNT**

Sleek and contemporary, ideal for installation under the worktop.

**FLUSH-MOUNT**

The product is sunk with a 1.5 mm deep recess making it perfectly flush with the worktop. Alternatively, it can also be installed on the worktop.

MANUFACTURING PROCESS

GROHE's collection of sinks covers every base, from entry-level models to sophisticated, minimalist designs. The way your sink is made will affect how durable, spacious and sleek it looks. Here are the three manufacturing types we use:

MOULDED SINKS

Each sink is moulded from a single sheet of high-quality stainless steel, using a press mould. Tap and waste holes are punched afterwards. This method creates sturdy sinks in even complex shapes, meaning a sink that is both durable and affordable.

MOULDED-WELDED SINKS

The sink's frame and bowl are press moulded in high-quality stainless steel before being welded together. This process allows for deeper bowls, more vertical walls inside and a slimmer radius between bowl and frame, for a sleek, modern look.

BENDED-WELDED SINKS

High-quality steel is laser cut to measure before being bent into the bowl shape. This bowl is then welded to the sink's frame. This method allows for crisper internal angles in the bowl with a very narrow radius – ideal for minimal sink designs. As there is no mould, the steel stays smoother and retains its original thickness, even at the bottom of the bowl.



PRODUCT LINES

Customise your kitchen space by choosing the perfect GROHE sink for you. Within our K-series, we offer you eight beautifully designed and durable product lines including 1, 1.5 or 2 bowl options. Various mounting types from built-in to undermount are available for your individual taste.



K500



K1000



K800



K400+



K400



K700 UNDERMOUNT



K700



K300



K200

30 270 ALO
Sink Mixer, high spout
with pull-out dual spray

GROHE K1000 SERIES

A superior sink designed for the demands of contemporary kitchens, the K1000 features a welded design with a diamond-shaped bottom, as well as a generous draining area. Its architectural style is matched by useful features like an included siphon and automatic waste fitting. It can be flush-mounted or built-in.

31 581 SD0
K1000 Kitchen Sink
Stainless steel kitchen sink
with 1 bowl



minimum cabinet size 80 cm



31 581 SD0
K1000 Kitchen Sink
Stainless steel kitchen sink
with 1 bowl

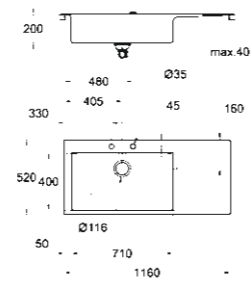

31 582 SD0
K1000 Kitchen Sink
Stainless steel kitchen sink
with 1 bowl

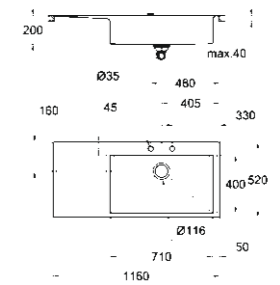

32 950 DC0
Professional Sink Mixer

GROHE K800 SERIES

Select a premium sink for your kitchen, in terms of both design and durability, with the K800. With crisp, contemporary lines and a diamond-shaped bottom. Select from 1 or 2 bowls, flush-mounted or built-in, and enjoy the added benefits of its space-saving siphon and automatic waste fitting with stylish waste basket cover.

31 584 SD0
K800 Kitchen Sink
Stainless steel kitchen sink
with 1 bowl



minimum cabinet size 120 cm

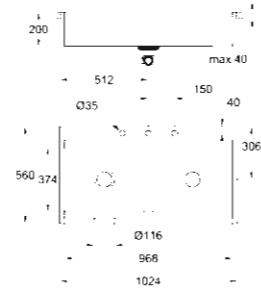

31 585 SD0
K800 Kitchen Sink
Stainless steel kitchen sink
with 2 bowls

minimum cabinet size 90 cm

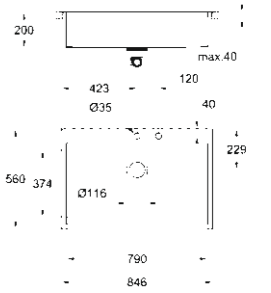

31 584 SD0
K800 Kitchen Sink
Stainless steel kitchen sink
with 1 bowl

minimum cabinet size 60 cm

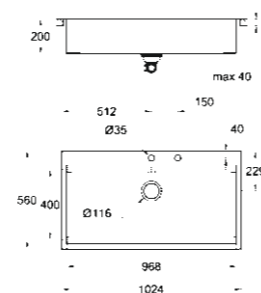

31 586 SD0
K800 Kitchen Sink
Stainless steel kitchen sink
with 1 bowl

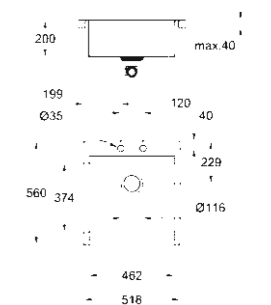

31 583 SD0
K800 Kitchen Sink
Stainless steel kitchen sink
with 1 bowl



GROHE K700 UNDERMOUNT SERIES

Get the uncluttered, architectural look with the K700 undermounted sink. With a deeper bowl and soft edges, it is designed to fit under your counter for a seamless, modern finish. Available in 1 or 1.5 bowl versions with bigger bowl on the left or right side.

31 577 SD0
K700 Undermount Kitchen Sink
Stainless steel kitchen sink
with 1.5 bowls

31 255 000
Sink Mixer, high spout

GROHE PVD UNRIVALLED, HARD AND SCRATCH RESISTANT

OUR HIGH-END PVD TECHNOLOGY BRINGS OUR NEW COLOURS TO LIFE

When it comes to a good design strategy, the choice of colours plays a vital part. But not only the colour, the quality of the finish is equally important. Especially in the world of bathroom and kitchen solutions and where surfaces ought to last for a long time, excellent, highly resistant finishes distinguish good products from great ones. GROHE's aspiration to always produce only the best drove us to choose a special technology that assures, not simply the best, most brilliant colours, but a durable coating of the highest quality. Our aim: to offer our consumers long-lasting water enjoyment. Next to the resistance of the material, it was also about the look of the colour itself: we wanted to make Brushed Hard Graphite as dark grey as possible and give our golden finishes the brilliance they deserve. That was the task for our technology team. In close collaboration with the GROHE design team, they achieved exceptional results working with a great new technology: PVD.



NEW COLOURS



minimum cabinet size 80 cm

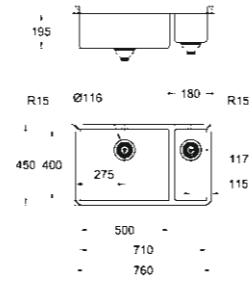

31 575 SD0
K700 Undermount Kitchen Sink
Stainless steel kitchen sink
with 1.5 bowls

minimum cabinet size 60 cm

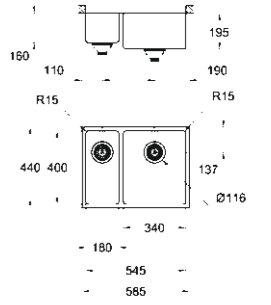

31 576 SD0
K700 Undermount Kitchen Sink
Stainless steel kitchen sink
with 1.5 bowls

minimum cabinet size 60 cm

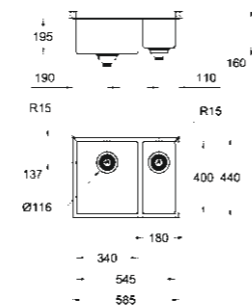

31 577 SD0
K700 Undermount Kitchen Sink
Stainless steel kitchen sink
with 1.5 bowls

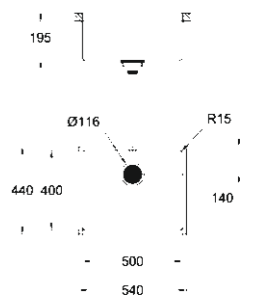

31 574 SD0
K700 Undermount Kitchen Sink
Stainless steel kitchen sink
with 1 bowl



Colour options:
● SD0 | SuperSteel

● GN0 | Brushed Cool Sunrise

● DL0 | Brushed Warm Sunset

● AL0 | Brushed Hard Graphite

GROHE K700 SERIES

Perfect for modern, minimalist kitchens, the K700 cubistic sink offers a deeper, larger bowl with radiant edges and a diamond-shaped bottom. Ideal for larger kitchens, the sink is available for standard built-in installation or flush-mounting and three different sizes.

30 294 000
Professional Sink Mixer

31 726 SD0
K700 Kitchen Sink
Stainless steel kitchen sink
with 1 bowl



minimum cabinet size 90 cm



31 580 SD0
K700 Kitchen Sink
Stainless steel kitchen sink
with 1 bowl

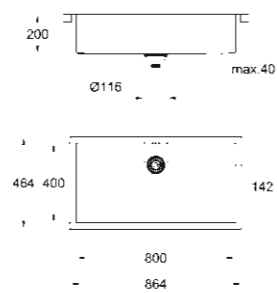

minimum cabinet size 60 cm



31 726 SD0
K700 Kitchen Sink
Stainless steel kitchen sink
with 1 bowl

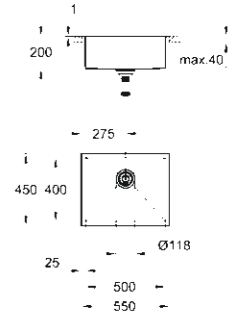

minimum cabinet size 45 cm



31 578 SD0
K700 Kitchen Sink
Stainless steel kitchen sink
with 1 bowl

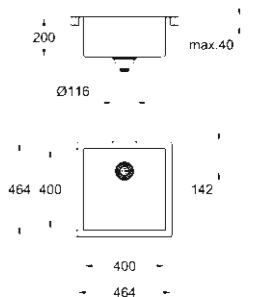



40 953 000
Waste Set
with pop-up and overflow

For even more comfort you can also
incorporate the waste set with pop-up
and overflow.

Fits to kitchen sinks series:
K700 and K700 Undermount.

GROHE K500 SERIES

In tough stainless steel, with welded finish for added durability, the K500 sink offers contemporary design chic with practical features. Choose a 1 or 1.5 bowl (reversible) model with drainer and automatic waste fitting.

31 573 SD0
Minta Sink Bundle

minimum cabinet size 80 cm

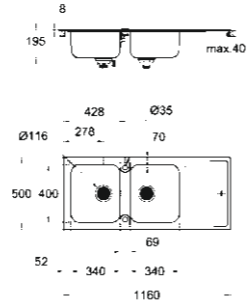

31 588 SD0
K500 Kitchen Sink
Stainless steel kitchen sink
with 2 bowls and reversible drainer

minimum cabinet size 45 cm

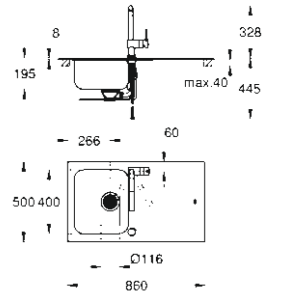

31 573 SD0
Minta Sink Bundle
Kitchen Tap and Sink Bundle
consisting of:
Stainless steel kitchen sink K500
Single lever sink mixer Minta
with pull-out mousseur

minimum cabinet size 60 cm

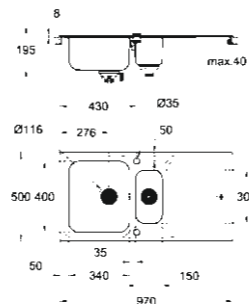

31 572 SD0
K500 Kitchen Sink
Stainless steel kitchen sink
with 1.5 bowls and reversible drainer

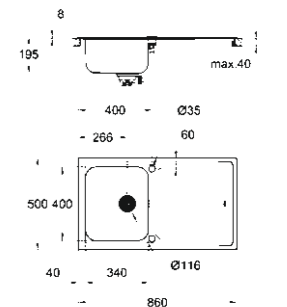

31 571 SD0
K500 Kitchen Sink
Stainless steel kitchen sink
with 1 bowl and reversible drainer



GROHE K400+ SERIES

30 273 DC1
Sink Mixer, medium spout
with pull-out dual spray

With the K400+ sink that uses AISI 316 grade stainless steel, GROHE offers an additional solution even for regions with a salty, rust-causing climate. The K400+ series comes with 1 or 1.5 bowl options. Both models are reversible and offer a 4 mm flat edge detail for a sleeker finish.

31 569 SD0
K400+ Kitchen Sink
Stainless steel kitchen sink
with 1.5 bowls and reversible drainer

minimum cabinet size 60 cm



31 569 SD0
K400+ Kitchen Sink
Stainless steel kitchen sink
with 1.5 bowls and reversible drainer

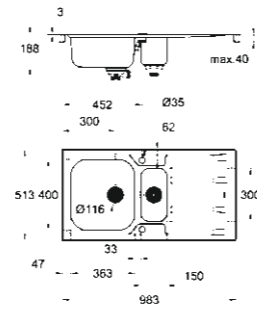

minimum cabinet size 45 cm



31 568 SD0
K400+ Kitchen Sink
Stainless steel kitchen sink
with 1 bowl and reversible drainer

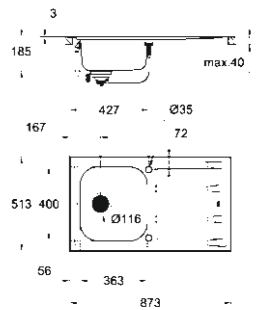

GROHE K400 SERIES

Give your kitchen a design-orientated edge with the K400 sinks. Sturdy and practical, but with distinctive design flair, the K400 sinks come in 1, 1.5 or 2 bowl options, with drainer. All models are reversible and come with standard built-in edge and remote waste.

31 570 SD0
Concetto Sink Bundle

minimum cabinet size 80 cm

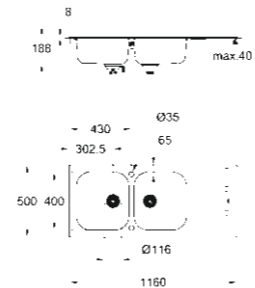

31 587 SD0
K400 Kitchen Sink
Stainless steel kitchen sink
with 2 bowls and reversible drainer

minimum cabinet size 45 cm

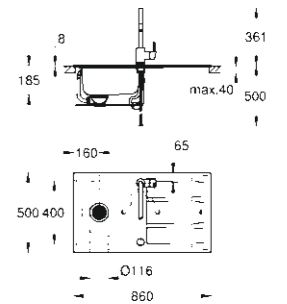

31 570 SD0
Concetto Sink Bundle
Kitchen Tap and Sink Bundle
consisting of:
Stainless steel kitchen sink K400
Single lever sink mixer Concetto
with pull-out mousseur

minimum cabinet size 60 cm

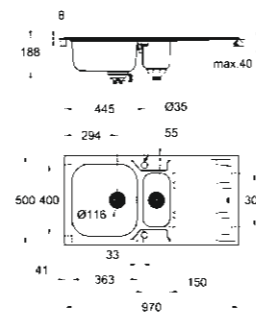

31 567 SD0
K400 Kitchen Sink
Stainless steel kitchen sink
with 1.5 bowls and reversible drainer

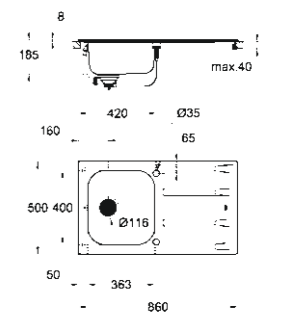

31 566 SD0
K400 Kitchen Sink
Stainless steel kitchen sink
with 1 bowl and reversible



GROHE K300 SERIES

Created for modern lifestyles, the smooth lines and soft edges of the K300 range of sinks will sit harmoniously with your kitchen. This fully reversible built-in sink comes in 1 or 1.5 bowl variations, with a drainer and automatic waste.

31 565 SD0
Eurosmart Sink Bundle

minimum cabinet size 60 cm

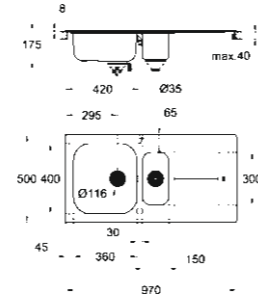

31 564 SD0
K300 Kitchen Sink
Stainless steel kitchen sink
with 1.5 bowls and reversible drainer

minimum cabinet size 45 cm

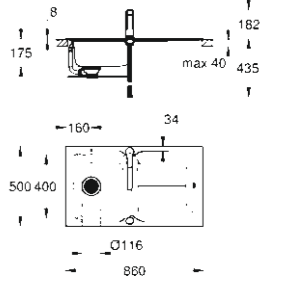

31 565 SD0
Eurosmart Sink Bundle
Kitchen Tap and Sink Bundle
consisting of:
Stainless steel kitchen sink K300
Single lever sink mixer Eurosmart
with swivel spout

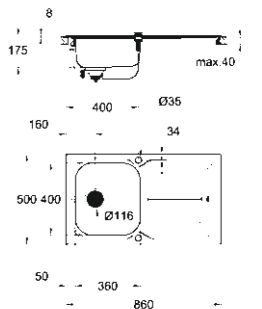

31 563 SD0
K300 Kitchen Sink
Stainless steel kitchen sink
with 1 bowl and reversible drainer



GROHE K200 SERIES

Versatile design that is a perfect fit for every home, K200 sinks are a durable, practical option for busy kitchens. With a single bowl, this model is a flexible, functional entry-level option suitable for any kitchen style. It is also available in a square model with rounded edges, and a round version.

31 562 SD0
Bau Sink Bundle



minimum cabinet size 45 cm



31 562 SD0
 Bau Sink Bundle
 Kitchen Tap and Sink Bundle
 consisting of:
 Stainless steel kitchen sink K200
 Single lever sink mixer BauEdge
 with swivel spout

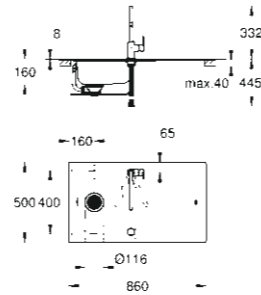

31 552 SD0
 K200 Kitchen Sink
 Stainless steel kitchen sink
 with 1 bowl and reversible drainer

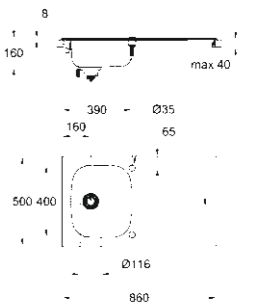

FIND THE PERFECT MATCH SINK AND TAP IN PERFECT HARMONY

Everything about the GROHE range of sinks has been designed for a perfect fit – with your tap, with your kitchen, with your lifestyle. All of the sinks have been designed to be paired effortlessly with our kitchen taps and watersystems, both in terms of design and practicality, with comfortable proportions and no splashing. To make it even easier to pick the right sink and tap for

you, we've also created four pre-packed sink and tap bundles, so you can buy your ideal sink and tap together, hassle-free. Encompassing our most popular lines, you can select a Bau, Eurosmart, Concetto or Minta sink bundle, making design, purchase and installation an even smoother, swifter process.



K1000	K800	K700 UNDERMOUNT	K700
SMARTCONTROL	SMARTCONTROL	SMARTCONTROL	SMARTCONTROL
EUROCUBE	ESSENCE	ESSENCE	MINTA
ESSENCE	K7	EUROCUBE	EUROCUBE
K7	GROHE BLUE HOME PULL-OUT	K7	ZEDRA
GROHE BLUE HOME PULL-OUT			K7
GROHE BLUE HOME	GROHE BLUE HOME + GROHE RED MONO	GROHE BLUE HOME + GROHE RED MONO	
GROHE RED II DUO			GROHE BLUE HOME + GROHE RED MONO

Colour options:
 ● Chrome / SuperSteel
 ● Warm Sunset / Brushed Warm Sunset

● Hard Graphite / Brushed Hard Graphite
 ● Cool Sunrise / Brushed Cool Sunrise

K500	K400+ / K400	K300	K200
MINTA	CONCETTO	EUROSMART	BAUEDGE
MINTA	EURODISC	EUROSMART COSMOPOLITAN	EUROSMART
MINTA	EURODISC COSMOPOLITAN	EUROSTYLE COSMOPOLITAN	

ALSO AVAILABLE AS A BUNDLE

MINTA SINK BUNDLE	CONCETTO SINK BUNDLE	EUROSMART SINK BUNDLE	BAU SINK BUNDLE

These are our design recommendations for **YOUR PERFECT MATCH**.
 Of course any other GROHE kitchen tap can be combined with our kitchen sinks.



COMPOSITE SINKS

PRODUCT FEATURES, FINISHES AND MOUNTING TYPES

Customise your kitchen space by choosing the ideal GROHE sink for you. Our K-series range of composite sinks covers every size, configuration and price point, so you're sure to find your perfect fit. The range includes round and square models in two different colours – Granite Black and Granite Grey. Select from 1, 1.5 or 2

bowl models, with or without a drainer, with dimensions suited to kitchens from the spacious to the compact. Plus choose between a neat top-mounted model or a sleek, minimalist under-mounted version which sits under the worktop.



GROHE QuickFix

Install your sink swiftly and easily thanks to the GROHE QuickFix system (kit supplied). With pre-punched tap holes most of our sinks are easily reversible, giving you the flexibility you need for any design scheme.



GROHE Whisper

Shhh! GROHE sinks reduce noise from running water and handling pots to a minimum, thanks to the dense mix of quartz and acrylic in our composite sinks.

QUARTZ COMPOSITE

Your sink can cope with the daily demands of even the busiest kitchen thanks to our innovative composite material. Using 76 % quartz – the hardest part of granite – mixed with acrylic resin, GROHE composite sinks are the toughest around. This hardened composite material is resistant to scratches, dents, stains, cracks and heat up to 280 °C. The smooth surface is easy to clean and 100 % food safe for total peace of mind.

Each GROHE composite sink is produced using a computerised polymerisation casting process which guarantees a seamless finish and total uniformity of colour throughout. What's more, the composite won't fade in UV light, meaning its certain to stay looking as good as the day you bought it.

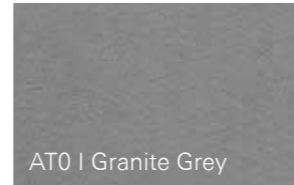

AT0 | Granite Grey

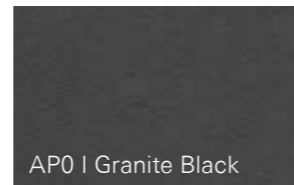

AP0 | Granite Black



EASY TO CLEAN

Your composite sinks is easy to keep clean so you will be able to enjoy its flawless finish for years to come.



NON FADING IN UV-LIGHT

Let the sunshine in! Our composite material won't fade in UV light, keeping your sink looking pristine and the colour-true.



SCRATCH-PROOF

Putting practicality first – made only from solid composite, these sinks are scratch-proof for a longer life.



HEAT RESISTANT UP TO 280 °C

Never hesitate to put down a hot pot again – GROHE composite sinks are heat resistant up to 280 °C for great durability.



SPACIOUS BOWLS

All GROHE composite sinks feature seamless bowls with a generous depth of at least 20 cm maximising space for washing large pots and filling vases with ease.



WASTE FITTING FOR EASY HANDLING

Thanks to the automatic waste your hands will stay clean and dry. For even more convenience, upgrade your sink with the stylish push-excenter (see pages 86/87).



STAIN RESISTANT

Because your sink has to be practical as well as beautiful, GROHE composite sinks are stain resistant for long-lasting good looks.



100 % FOOD SAFE

Enjoy total confidence in using your kitchen your way – GROHE composite sinks are 100 % food safe, making prep easy and hygienic.



TOPMOUNT

A traditional built-in look with a vertical 8 mm edge. Installation is with clips (except for models 31 653, 31 654, 31 655 and 31 648 – silicone only).



UNDERMOUNT

Installed under the worktop for a sleek, contemporary look.

MANUFACTURING PROCESS

GROHE's collection of sinks covers every base, from entry-level models to sophisticated, minimalist designs. Across the whole range the innovative manufacturing process works hand-in-hand with the durable quartz composite to create sinks that are tough and durable.

Each sink is produced using a computer controlled polymerisation casting process which gives complete uniformity of colour and a seamless, hardened, coating-free finish. The molding process means all sinks offer a generous minimum depth of 20 cm, and thanks to the dense composite you'll also find GROHE sinks to be significantly quieter than stainless steel models.



PRODUCT LINES

An option for every kitchen – our composite sink ranges cover every style, size and price point so you're sure to find your perfect model. The composite sinks come as round and square models and in two contemporary colours – Granite Black and Granite Grey. Select from 1, 1.5 or 2 bowl models, with or without a drainer and either as neat top-mounted version or a sleek minimalist under-mounted. The choice really is all yours.



K700 UNDERMOUNT



K700



K500



K400



K200

new

GROHE K700 UNDERMOUNT SERIES

Create a sleek, minimalist look for your kitchen with the K700 Undermount series. Mounted below the worktop for a clean, seamless look, this style is an ideal fit for modern, architectural kitchens. These single bowl sinks come with clips to make mounting easy and an optional automatic waste-fitting with push-to-open technology. All sinks in the K700 Undermount series can also be installed top-mounted for a more traditional look.



Topmount installation



Upgrade your sink with the stylish GROHE Push Excenter (fits to all composite series)



32 950 DC0
Professional Sink Mixer
with dual spray

40 986 SD0
Push-Excenter
with pop-up

31 654 AP0
K700 Undermount Kitchen Sink
Composite kitchen sink
with 1 bowl

new

minimum cabinet size 70 cm

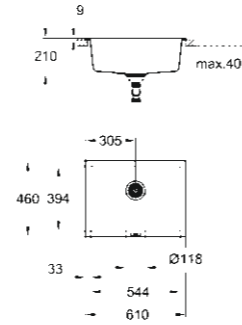

● ●
31 655 AP0
 K700 Undermount Kitchen Sink
 Composite kitchen sink
 with 1 bowl

minimum cabinet size 60 cm

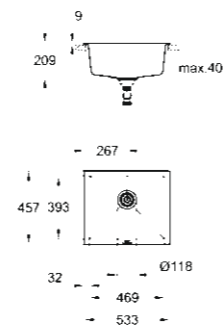

● ●
31 654 AP0
 K700 Undermount Kitchen Sink
 Composite kitchen sink
 with 1 bowl

minimum cabinet size 50 cm

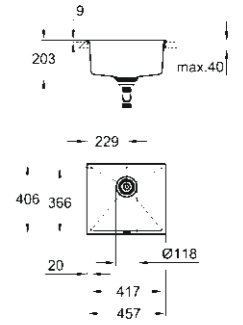

● ●
31 653 AP0
 K700 Undermount Kitchen Sink
 Composite kitchen sink
 with 1 bowl



Colour options:
 ● AT0 | Granite Grey ● AP0 | Granite Black

new

GROHE K700 SERIES

The K700 series of composite sinks offers you premium features and performance, with a deep bowl and generous proportions making them large enough for any kitchen task. Available in 1 and 2 bowl options, models are designed to be top-mounted, with some also suitable for more minimalist under-mounting. K700 series sinks are available with automatic waste-fitting and optional push-to open technology.



30 294 DC0
Professional Sink Mixer
with dual spray

31 652 AP0
K700 Kitchen Sink
Composite kitchen sink
with 1 bowl

new

minimum cabinet size 100 cm

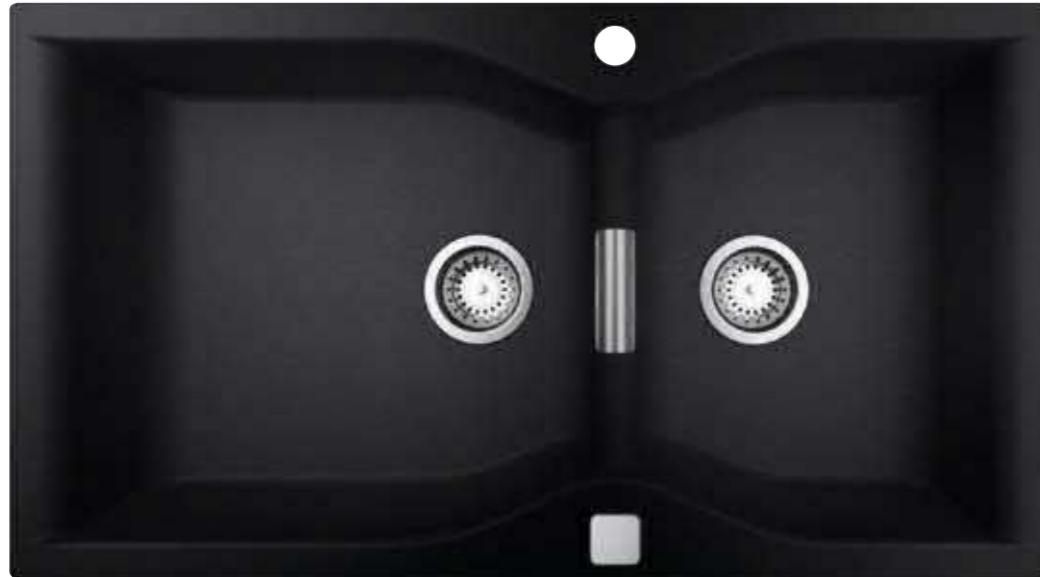

● ●
31 658 AP0
 K700 Kitchen Sink
 Composite kitchen sink
 with 2 bowls, reversible

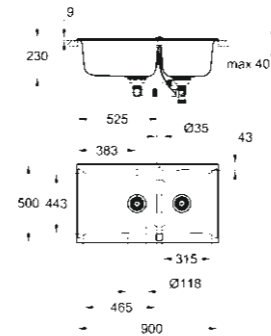

minimum cabinet size 90 cm



● ●
31 657 AP0*
 K700 Kitchen Sink
 Composite kitchen sink
 with 2 bowls

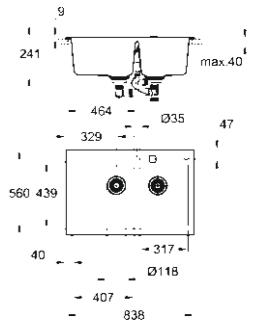

* Can also be installed under the worktop.

Colour options:
 ● AT0 | Granite Grey ● AP0 | Granite Black



new

minimum cabinet size 80 cm

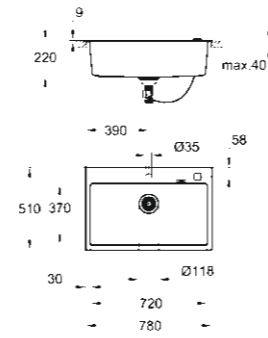

● ●
31 652 AP0
 K700 Kitchen Sink
 Composite kitchen sink
 with 1 bowl

minimum cabinet size 60 cm

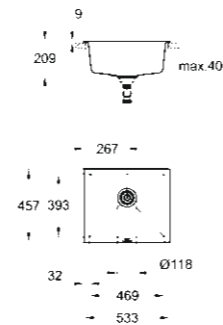

● ●
31 651 AP0
 K700 Kitchen Sink
 Composite kitchen sink
 with 1 bowl

minimum cabinet size 50 cm

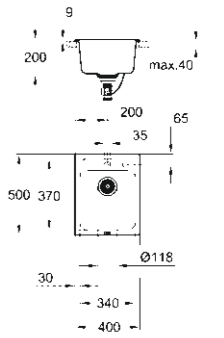

● ●
31 650 AP0
 K700 Kitchen Sink
 Composite kitchen sink
 with 1 bowl



Colour options:
 ● AT0 | Granite Grey ● AP0 | Granite Black

new

GROHE K500 SERIES

Combine durability with spacious proportions and streamlined looks with the K500 series of composite sinks. This flexible collection features 1, 1.5 and 2 bowl options, with integrated drainers available on some models. For an architectural look select an undermounted design or fit the more conventional top-mounted models. K500 series sinks are available with automatic waste-fitting and optional push-to open technology.



30 270 ALO
Sink Mixer, high spout

31 648 AP0*
K500 Kitchen Sink
Composite kitchen sink
with 1.5 bowls

* Can also be installed under the worktop.

new

minimum cabinet size 90 cm

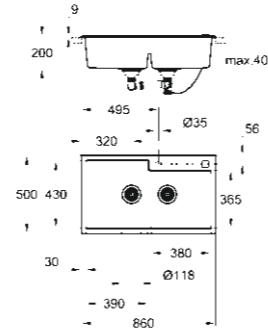

● ●
31 649 AP0
 K500 Kitchen Sink
 Composite kitchen sink
 with 1 bowl

minimum cabinet size 60 cm

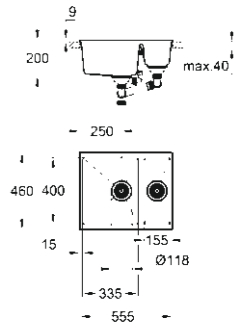

● ●
31 648 AP0*
 K500 Kitchen Sink
 Composite kitchen sink
 with 1.5 bowls

minimum cabinet size 80 cm

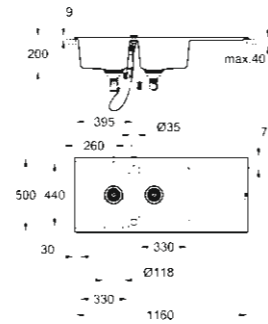

● ●
31 647 AP0
 K500 Kitchen Sink
 Composite kitchen sink
 with 2 bowls and reversible drainer

* Can also be installed under the worktop.



Colour options:
 ● AT0 | Granite Grey ● AP0 | Granite Black

new

minimum cabinet size 60 cm

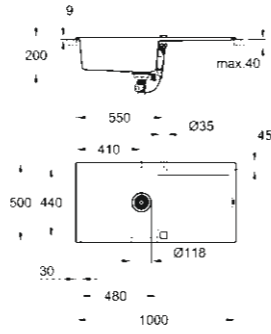

● ●
31 645 AP0
 K500 Kitchen Sink
 Composite kitchen sink
 with 1 bowl and reversible drainer

minimum cabinet size 50 cm

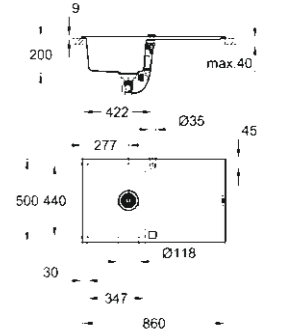

● ●
31 644 AP0
 K500 Kitchen Sink
 Composite kitchen sink
 with 1 bowl and reversible drainer

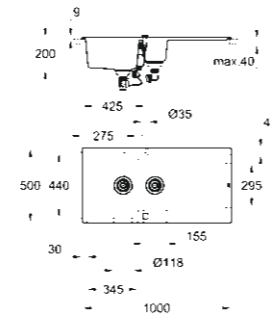

● ●
31 646 AP0
 K500 Kitchen Sink
 Composite kitchen sink
 with 1.5 bowls and reversible drainer



Colour options:
 ● AT0 | Granite Grey ● AP0 | Granite Black

new

GROHE K400 SERIES

Combine sturdy practicality, visual flair and great design flexibility with a K400 series composite sink. Designed to be fully-reversible, these top-mounted sinks come in 1 and 1.5 bowl models, all with automatic waste-fitting and optional push-to open technology.



31 483 002
Sink Mixer, high spout

31 642 AP0
K400 Kitchen Sink
Composite kitchen sink
with 1.5 bowls and reversible drainer

new

minimum cabinet size 80 cm



● ●
31 643 AP0
 K400 Kitchen Sink
 Composite kitchen sink
 with 1.5 bowls and reversible drainer

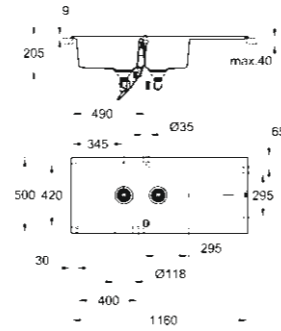

minimum cabinet size 60 cm



● ●
31 642 AP0
 K400 Kitchen Sink
 Composite kitchen sink
 with 1.5 bowls and reversible drainer

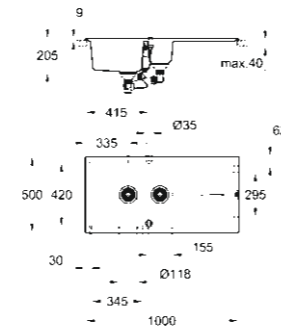

minimum cabinet size 60 cm



● ●
31 641 AP0
 K400 Kitchen Sink
 Composite kitchen sink
 with 1 bowl and reversible drainer

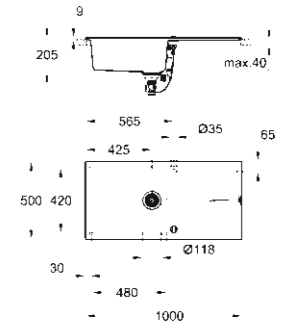

minimum cabinet size 50 cm



● ●
31 640 AP0
 K400 Kitchen Sink
 Composite kitchen sink
 with 1 bowl and reversible drainer

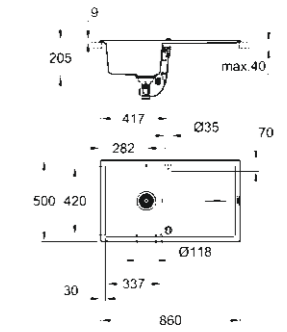

Colour options:
 ● AT0 | Granite Grey ● AP0 | Granite Black

new

GROHE K200 SERIES

With the K200 series we've thought of everything. This great all-rounder is an ideal sink for your basic kitchen needs, and is also ideal for compact spaces or islands. The round K200 composite sink is as practical and durable as all of our sinks. Designed to be top-mounted, this single bowl sink comes with optional push-to open technology.



31 368 000
Sink Mixer

31 656 AP0
K200 Kitchen Sink
Composite kitchen sink
with 1 bowl

new

minimum cabinet size 50 cm



● ●
31 656 AP0
K200 Kitchen Sink
Composite kitchen sink
with 1 bowl

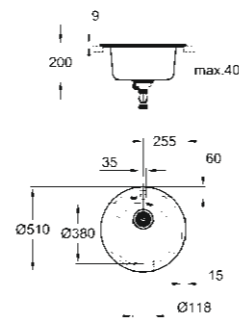

Colour options:
● AT0 | Granite Grey ● AP0 | Granite Black



FIND THE PERFECT MATCH SINK AND TAP IN PERFECT HARMONY

Everything about the GROHE range of sinks has been designed for a perfect fit – with your tap, with your kitchen, with your lifestyle. All of the sinks have been designed to be paired effortlessly with our kitchen taps and watersystems, both in terms of

design and practicality, with comfortable proportions and no splashing. The sinks are available in two colours, both perfectly matched to new GROHE Colour options for brassware, which includes Hard Graphite and Warm Sunset colour options.

**K700 / K700
UNDERMOUNT**



ESSENCE



K7



EUROCUBE



ATRIO



SMARTCONTROL



GROHE BLUE HOME PULL-OUT

K500



MINTA



EUROSMART



EUROSMART



ZEDRA



EURODISC COSMOPOLITAN



CONCETTO



EUROSTYLE COSMOPOLITAN



EURODISC COSMOPOLITAN



BAULOOP



EUROSMART



CONCETTO



EUROSTYLE COSMOPOLITAN



EURODISC COSMOPOLITAN

K200



BAULOOP



EUROSMART



CONCETTO

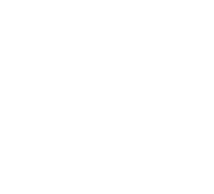

EUROSTYLE COSMOPOLITAN











EURODISC COSMOPOLITAN

These are our design recommendations for **YOUR PERFECT MATCH**.
Of course any other GROHE kitchen tap can be combined with our kitchen sinks.

- Colour options:**
- Chrome / SuperSteel
 - Warm Sunset / Brushed Warm Sunset
 - Hard Graphite / Brushed Hard Graphite
 - Cool Sunrise / Brushed Cool Sunrise





PRODUCT FEATURES OVERVIEW

STAINLESS STEEL SINKS

	STANDARD BUILT-IN	FLAT-EDGE	FLUSH-MOUNT	UNDERMOUNT	NUMBER OF BOWLS & RADIUS			DRAINER AVAILABLE	MATERIAL		FINISH		ADDITIONAL FEATURES			
					1	1.5	2	INNER RADIUS	AISI 304 (V2A)	AISI 316 (V4A)	SATIN FINISH	PRE-POLISHED	PRE-PUNCHED TAP HOLES	REVERSIBLE SINK	AUTOMATIC WASTE FITTING INCLUDED	BUNDLE AVAILABLE
 K1000			●		●			R0 / R30*	●	●	●		●		●	
 K800			●		●		●	R0	●		●		●		●	
 K700 U			●	●	●			R0 / R9**	●		●				***	
 K700			●		●			R15	●		●				***	
 K500	●				●	●	●	R60	●	●	●		●	●	●	●
 K400+		●			●	●		R95	●		●		●	●	●	
 K400	●				●	●	●	R95	●	●	●		●	●	●	●
 K300	●				●	●		R95	●	●	●		●	●	●	●
 K200	●				●	●		R95	●	●		●	●	●	●	●

* R0 (bottom, front & back top) / R30 (right & left top)
 ** R0 (vertical) / R9 (bottom)
 *** optional accessory 40 953 000

COMPOSITE SINKS

	STANDARD BUILT-IN	UNDERMOUNT	NUMBER OF BOWLS & RADIUS			DRAINER AVAILABLE	MATERIAL	ADDITIONAL FEATURES		
			1	1.5	2	INNER RADIUS	COMPOSITE	PRE-PUNCHED TAP HOLES	REVERSIBLE SINK	AUTOMATIC WASTE FITTING INCLUDED
 K700 U	●	●	●			R0 / R30*	●			●
 K700	●	○	●	●	●	R0	●	●	○	●
 K500	●	○	●	●		R0 / R9**	●	●	○	●
 K400	●		●	●		R15	●	●	●	●
 K200	●		●			R60	●	●		●

○ selected products
 ● all products in this line

GROHE KITCHEN SYSTEMS

PERFECT SOLUTIONS FOR THE CENTER OF YOUR KITCHEN



ACCESSORIES



COMPOSITE



STAINLESS STEEL



PVD



WATERSYSTEMS



GROHE BLUE PURE

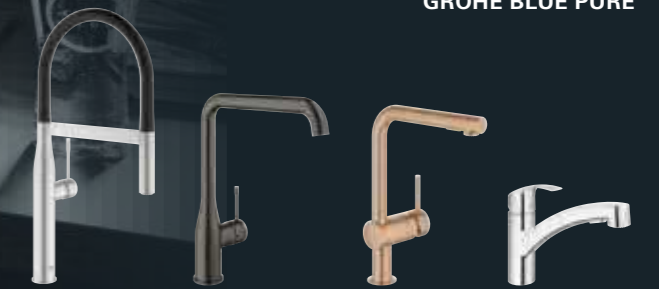

TAPS



GROHE BLUE / RED WATERSYSTEMS



WASTE SYSTEMS

DISCOVER THE WORLD OF GROHE

If you're looking for ideas or solutions for your bathroom and kitchen, the **GROHE Media APP** is where you will find your inspiration. With a new name and a fresh new look for March 2019, this app puts all the latest content from GROHE – magazines, videos, books and brochures – at your fingertips. This is just a small selection of what the world of GROHE has to offer: the perfect addition to your GROHE home.

GET IT HERE

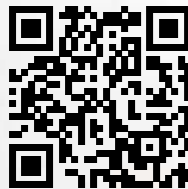

VISIT US ONLINE AND FOLLOW US ON SOCIAL MEDIA

FACEBOOK [grohe.enjoywater](https://www.facebook.com/grohe.enjoywater) | INSTAGRAM [grohe_global](https://www.instagram.com/grohe_global)
 TWITTER [grohe](https://twitter.com/grohe) | YOUTUBE [grohe](https://www.youtube.com/grohe) | PINTEREST [grohe](https://www.pinterest.com/grohe)



System requirements
 iPhone with iOS 11.0 or higher / smart phone with Android 6.0 or higher The Bluetooth® word mark and logos are registered trademarks owned by Bluetooth SIG, Inc. and any use of such marks by Grohe AG is under license. Other trademarks and trade names are those of their respective owners. Apple, the Apple logo, iPod, iPod Touch, iPhone and iTunes are trademarks of Apple Inc., registered in the U.S. and other countries. Apple is not responsible for the function of this device or its compliance with safety and regulatory standards.



Follow us



Just scan the QR code to view the latest brochure as download or PDF on your tablet or smartphone.



QUALITY

*"No.1 most trusted brand in the sanitary industry" –
Wirtschaftswoche, 2017*



TECHNOLOGY

*"Top 50 companies to change the world" –
Fortune Magazine, 2017*



DESIGN

Over 400 design awards won since 2003



SUSTAINABILITY

CSR Award winner of the German Government, 2017

GROHE Limited
World Business Centre 2
Newall Road
London Heathrow Airport
Hounslow
Middlesex
TW6 2SF
Tel: 0208 283 2840
Fax: 0871 200 3415
email: info-uk@grohe.com

© 08/2019 – Copyright by GROHE

www.parsital.com

PART OF **LIXIL**